



ROOM CAPACITIES & SPECIFICATIONS

University of Wisconsin-Madison • Conference Centers



PYLE CENTER

With more than 135,000 square feet of space in the heart of Madison, Pyle Center is more than your typical conference center — it's where the Wisconsin Idea comes to life. Everything from multimedia presentations and multi-day conferences to advanced distance education systems and active learning labs happen here — all from Pyle Center.



PLYLE CENTER

Lower Level

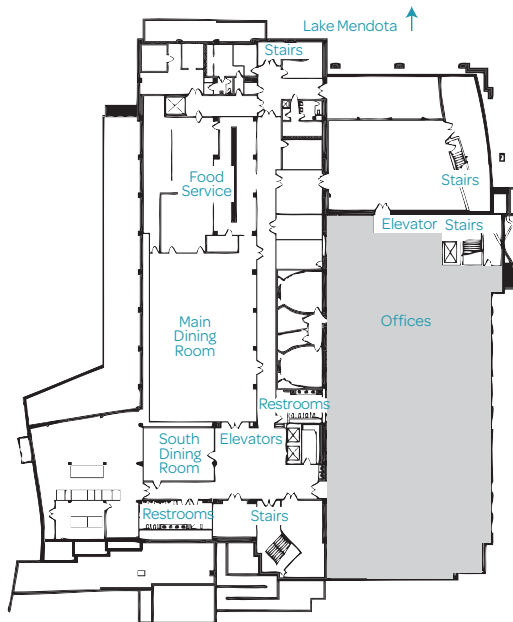

First Level

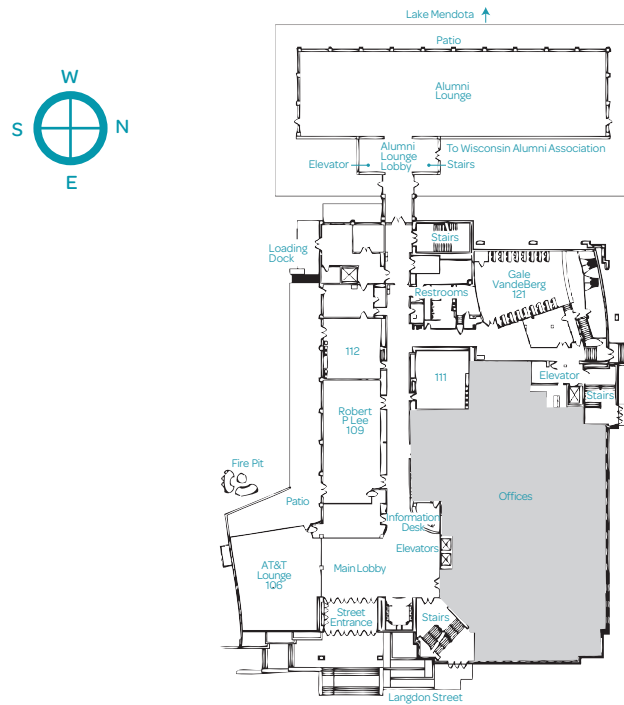

Second Level



Third Level

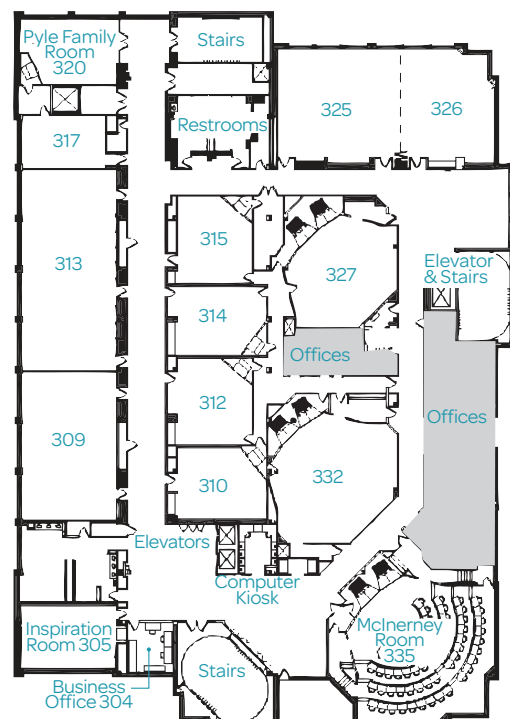

PYLE CENTER

Whether you're planning a day of meetings for a few dozen, or a week-long conference for hundreds, our Event Planners can provide you with the guidance and support you need to host the perfect event. Our reputation for excellence is built on more than half a century of experience organizing unique meetings, conferences and other special events.

Room Size

S	700 square feet or less
M	1,300 square feet or less
L	More than 1,300 square feet

Room #	Type	Dimensions	Wkrshp 5 per 2	Herringbone	Lecture	Hollow Sq.	U-Shape	Solid/Board	Rounds
217 (S)	Classroom	16' x 26'	20	15	30	16	12	16	10
317 (S)	Classroom	16' x 26'	20	15	30	16	12	16	10
320 (S)	Board Room	20' x 32'	n/a	n/a	n/a	n/a	n/a	18	n/a
310 (S)	Distance Ed./ Board	22' x 28'	n/a	n/a	n/a	n/a	n/a	12	n/a
312 (S)	Distance Ed.	27' x 28'	n/a	12	n/a	n/a	n/a	n/a	n/a
314 (S)	Distance Ed.	22' x 31'	n/a	15	n/a	n/a	n/a	n/a	n/a
315 (S)	Distance Ed.	23' x 27'	n/a	12	n/a	n/a	n/a	n/a	n/a
111 (M)	Classroom	27' x 29'	35	30	72	24	20	n/a	n/a
112 (M)	Classroom	29' x 30'	35	30	88	24	17	n/a	n/a
205 (S)	Classroom	20' x 30'	26	25	56	24	18	n/a	n/a
220 (S)	Classroom	21' x 31'	30	25	52	24	20	n/a	n/a
225 (M)	Classroom	29' x 34'	40	36	72	30	20	n/a	n/a
227 (M)	Distance Ed.	31' x 34'	22	n/a	n/a	n/a	n/a	n/a	n/a
232 (L)	Distance Ed.	36' x 38'	40	n/a	n/a	n/a	n/a	n/a	n/a
326 (M)	Classroom	34' x 29'	45	30	76	28	20	n/a	n/a
327 (M)	Distance Ed.	31' x 34'	20	n/a	n/a	n/a	n/a	n/a	n/a
332 (L)	Distance Ed.	36' x 38'	32	n/a	n/a	n/a	n/a	n/a	n/a
121 (L)	Auditorium	34' x 48'	n/a	n/a	100	n/a	n/a	n/a	n/a
209 (L)	Classroom	30' x 61'	66	60	144	36	n/a	n/a	40
213 (L)	Classroom	30' x 47'	65	55	120	40	30	n/a	n/a
226 (L)	Classroom	34' x 38'	50	55	100	30	24	n/a	n/a
235 (L)	Distance Ed.	42' x 42'	55	n/a	n/a	n/a	n/a	n/a	n/a
309 (L)	Classroom	29' x 46'	65	60	120	40	30	n/a	n/a
313 (L)	Classroom	30' x 63'	100	80	180	50	42	n/a	n/a
325 (L)	Classroom	34' x 39'	65	50	120	34	30	n/a	n/a
325/326 (L)	Classroom	34' x 68'	130	95	240	60	50	n/a	n/a
335 (L)	Distance Ed.	42' x 42'	55	n/a	n/a	n/a	n/a	n/a	n/a
204	Business Office	14' x 16'	n/a	n/a	n/a	n/a	n/a	n/a	n/a
304	Business Office	14' x 15'	n/a	n/a	n/a	n/a	n/a	n/a	n/a

LOWELL CENTER



Blending the quiet comfort of home with modern event amenities, Lowell Center features 137 guestrooms, the area's largest indoor pool with sauna, an all-new modern fitness center and a spacious dining room. Located at 610 Langdon Street, Lowell Center offers tranquil views of Lake Mendota and is just walking distance from vibrant State Street.

Room #	Type	Dimensions	Wkrshp 5 per 2	Herringbone	Lecture	Hollow Sq.	U-Shape	Solid/Board
Monona Room (S)	Board Room	12' x 18'	n/a	n/a	n/a	n/a	n/a	10
Waubesa Room (S)	Board Room	12' x 18'	n/a	n/a	n/a	n/a	n/a	10
Wingra Room (S)	Board Room	12' x 18'	n/a	n/a	n/a	n/a	n/a	10
Mendota Room (S)	Classroom	36' x 25'	40	30	64	28	24	n/a
Langdon Room (L)	Classroom	36' x 25'	30	25	60	26	25	n/a
Isthmus South (L)	Classroom		36	25	80	24	22	n/a
Isthmus North (L)	Classroom		60	40	108	40	30	n/a
Isthmus North (L) + South (L)	Classroom		100	60	230	56	46	n/a

Lower Level

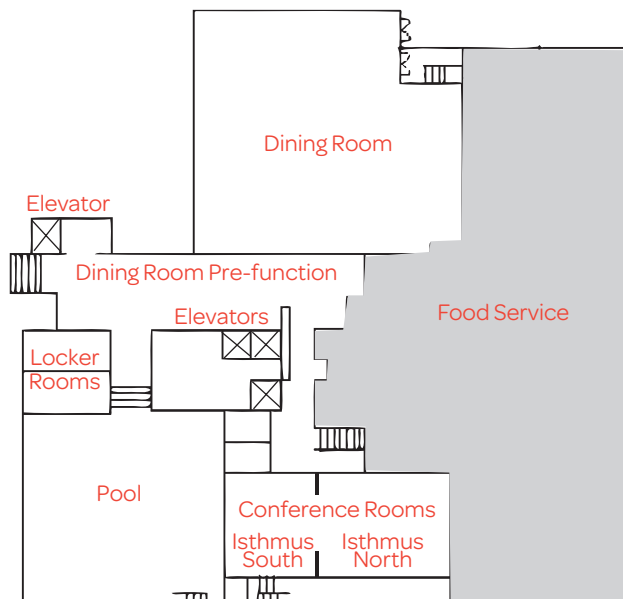

First Level

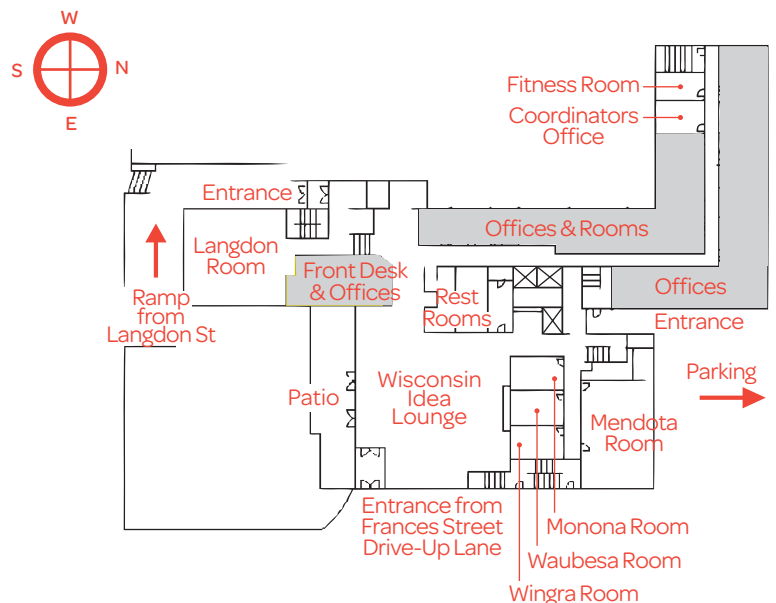

DINING, LOUNGES & PATIOS

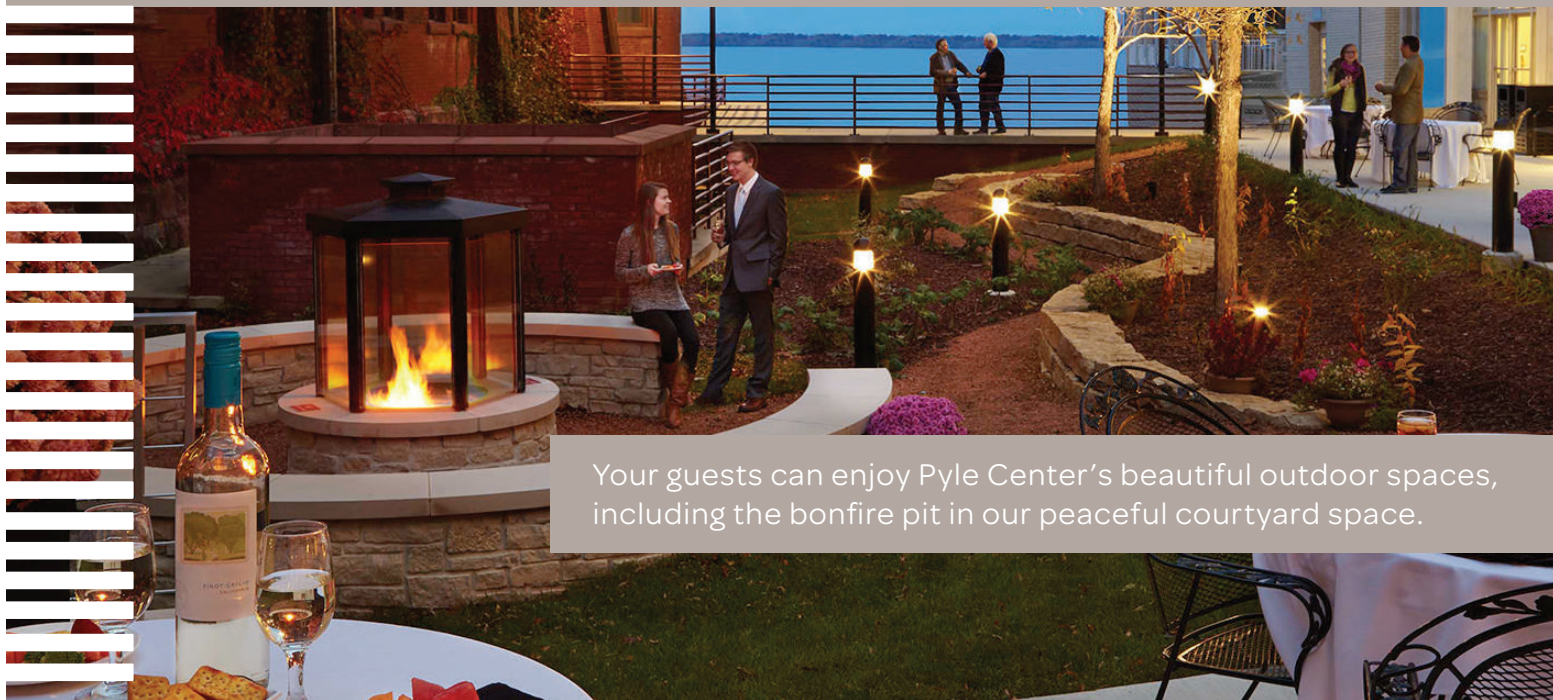

Your guests can enjoy Pyle Center's beautiful outdoor spaces, including the bonfire pit in our peaceful courtyard space.

Building	Room	Type	Dimensions	Wrkshp 5 per 2	Lecture	Rounds	Rounds/ AV/Plated	Rounds/ AV/Buffer	Rounds/ Buffer
Pyle Center	2-PreEast	Open Space	26' x 25'	n/a	n/a	n/a	n/a	n/a	n/a
Pyle Center	2-PreSouth	Open Space	24' x 25'	n/a	n/a	n/a	n/a	n/a	n/a
Pyle Center	3-PreEast	Open Space	26' x 25'	n/a	n/a	n/a	n/a	n/a	n/a
Pyle Center	3-PreSouth	Open Space	24' x 25'	n/a	n/a	n/a	n/a	n/a	n/a
Pyle Center	305 (S)	Lounge/Meeting Space	30' x 30'	n/a	n/a	n/a	n/a	n/a	n/a
Pyle Center	Alumni Lounge	Lounge	32' x 73'	n/a	300	190	170	140	160
Pyle Center	106 - AT&T Lounge	Lounge	51' x 42'	70	220	130	120	110	120
Pyle Center	109 - Lee Lounge	Lounge	29' x 62'	n/a	180	120	110	90	110
Pyle Center	Wisconsin Ideas Lounge	Lounge	46' x 70'	n/a	n/a	230	190	n/a	210
Pyle Center	Van Hise Lounge	Lounge	23' x 30'	n/a	n/a	50	n/a	n/a	40
Pyle Center	Courtyard	Patio/Outdoor	16'x 98'/ 34'x20'	n/a	n/a	n/a	n/a	n/a	n/a
Pyle Center	Rooftop	Patio/Outdoor	62'x63'	n/a	n/a	n/a	n/a	n/a	n/a

Building	Room	Type	Dimensions	Wrkshp 5 per 2	Lecture	Rounds	Rounds/ AV/Plated	Rounds/ AV/Buffer	Rounds/ Buffer
Lowell Center	Dining Room	Lounge	57' x 70'	n/a	n/a	310	310	n/a	n/a
Lowell Center	Buckingham Lounge	Lounge	55' x 43'	n/a	n/a	n/a	n/a	n/a	n/a

ROOM CONFIGURATIONS



Chair:  Table: 

Herringbone

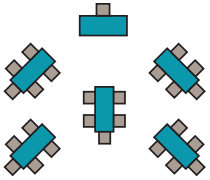

Lecture or Theater

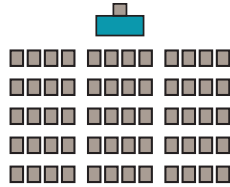

Workshop or Classroom

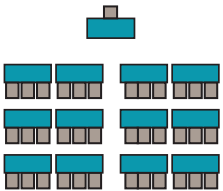

Banquet

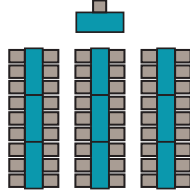

Hollow Square

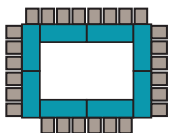

U-Shape

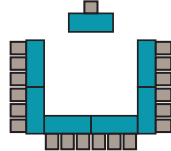

Circle

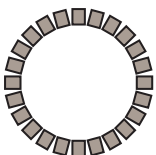

Half Circle

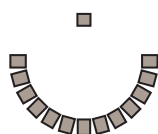

Our beautiful rooftop terrace features stunning views of Lake Mendota and can hold receptions for up to 400 guests.

Some rooms have fixed furniture arrangements and can't be modified. Rooms are normally set with a standard configuration that is optimal for the space. There is no charge for the initial room setup; however, additional fees may apply for extreme deviations from our standard setup, for last-minute changes or major midday alterations. To the left are diagrams of optional configurations for conference rooms with movable furniture. Audiovisuals may reduce room capacities.

FEATURES & AMENITIES

We take pride in providing services and amenities that exceed guests' expectations:

- We offer eight-hour chairs that ensure comfort throughout daylong events or classes. Our chairs are specifically designed to meet the needs of conference participants.
- Both conference centers are fully supported with educational technology specialists, which means you will always have support and help readily available.
- Guest Services is conveniently located on our first floor.
- Wall-mounted tack boards allow for easy hanging of display and presentation materials.
- We offer full food and beverage service.
- Meeting rooms refreshed at lunch and during breaks.
- Complimentary filtered water service provided on all floors.
- Both facilities provide free wireless internet access throughout.
- Phone service is available in meeting rooms.
- Both facilities welcome users with special needs. We offer assisted listening devices, closed captioning and video calls for anyone using sign language, and our facilities are fully accessible to those with physical challenges.
- Business offices available at Pyle Center and Lowell Center
- Full service, on-site Registration Services
- 137 Guest Rooms



Catering Services

At Lowell and Pyle Centers, our catering staff can provide all of your event's food and beverage needs – from meals to receptions to breaks. Our packages make it easy for planners to accommodate various budget levels and special dietary needs.



CONTACT



LOWELL CENTER

610 Langdon Street
Madison, WI 53703
(608) 256-2621
lowell@lowell.wisc.edu
lowell.wisc.edu



PYLE CENTER

702 Langdon Street
Madison, WI 53706
(608) 262-0881
pylecenter@pyle.wisc.edu
pyle.wisc.edu

To start planning your event,
call one of our event planners
at (608) 262-0881 or email
schedule@pyle.wisc.edu.

You can also learn more about
our services, and even submit a
space request form online at
pyle.wisc.edu.